

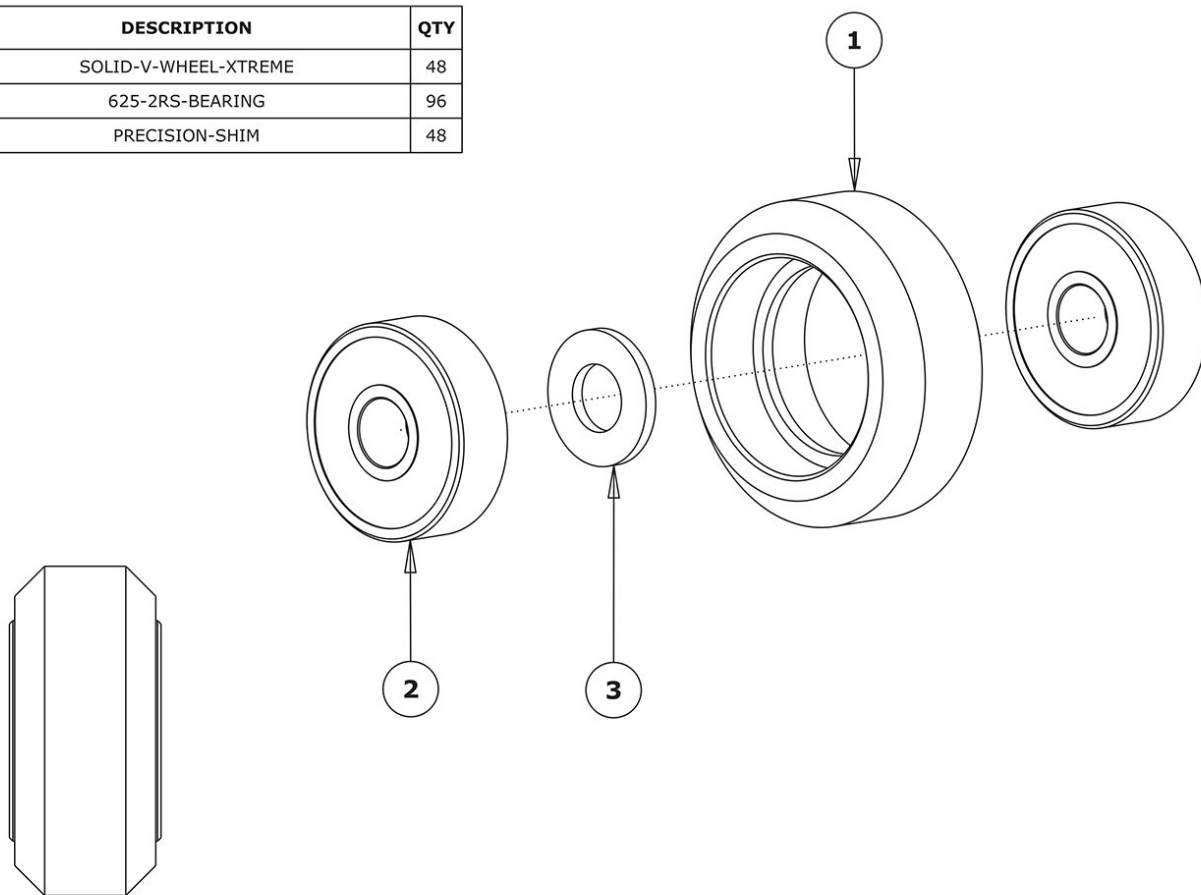

1. Wheel Assembly

Written By: Harry Ince

ITEM NO	DESCRIPTION	QTY
1	SOLID-V-WHEEL-XTREME	48
2	625-2RS-BEARING	96
3	PRECISION-SHIM	48



Step 1 — Solid V Xtreme Wheel Assembly

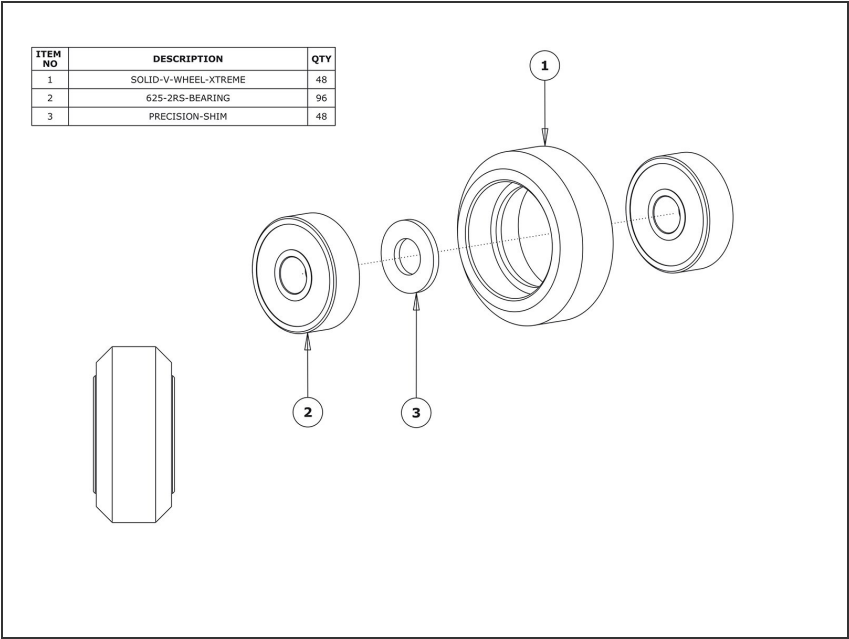

- From the Solid-V-Wheel-Xtreme-Kit packet, with a Precision-Shim in between, insert a 625-2RS-Bearing into either side of the Solid-V-Wheel-Xtreme.
- Repeat this for 48 Solid-V-Wheel-Xtreme-Kits. 49 kits are provided, do not assemble the spare one, these can be used for parts if any of the other packets are missing anything.
- There will be 48 x Precision-Shims left over from the Solid-V-Wheel-Xtreme-Kits, these can be added to the Precision-Shim packet in the ‘Brackets & Spacers’ box for use later.

Step 2 — Mini V Wheel Assembly

ITEM NO	DESCRIPTION	QTY
1	MINI-V-WHEEL	4
2	MINI-V-BEARING	8
3	MINI-V-PRECISION-SHIM	4

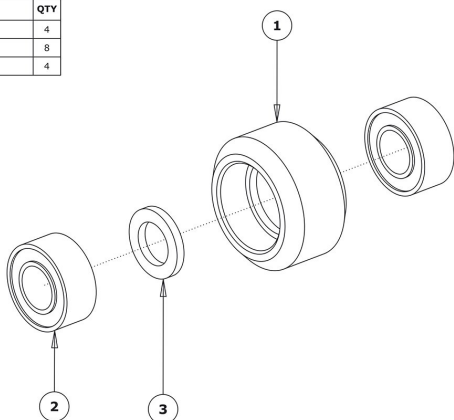

- From the Mini-V-Wheel-Kit packet, with a Mini-V-Precision-Shim in between, insert a Mini-V-Bearing into either side of the Mini-V-Bearing.
- Repeat this for all 4 Mini-V-Wheel-Kits.
- There will be 4 x Mini-V-Precision-Shims left over in the Mini-V-Wheel-Kits, these can be added to the Mini-V-Precision-Shim packet in the 'Brackets & Spacers' box for use later. The left over nuts in the Mini-V-Wheel-Kit packet can be discarded.

Thanks for following the guide. Any issues, please contact us!